

10U for Arai Integraal Helmen Snelstartgids

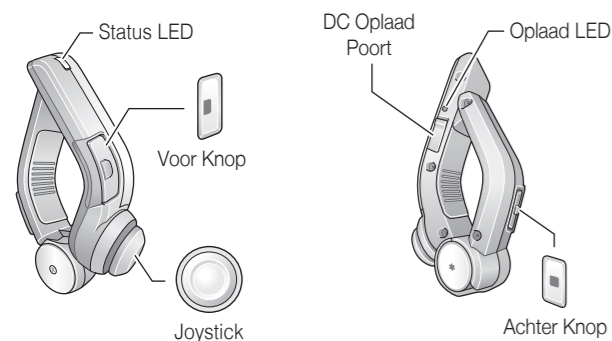

Installatie

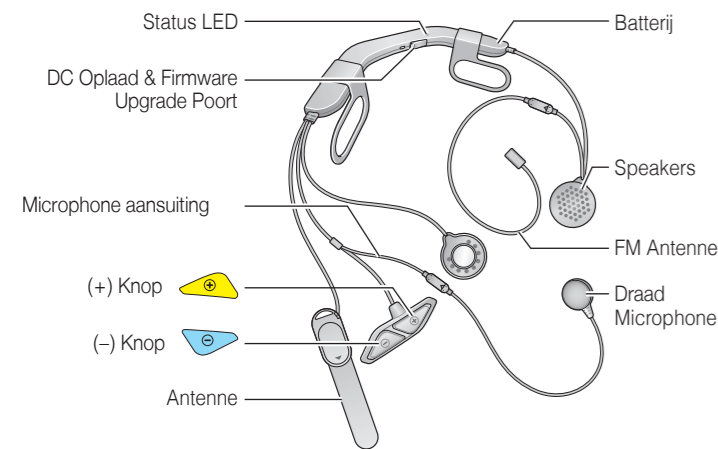
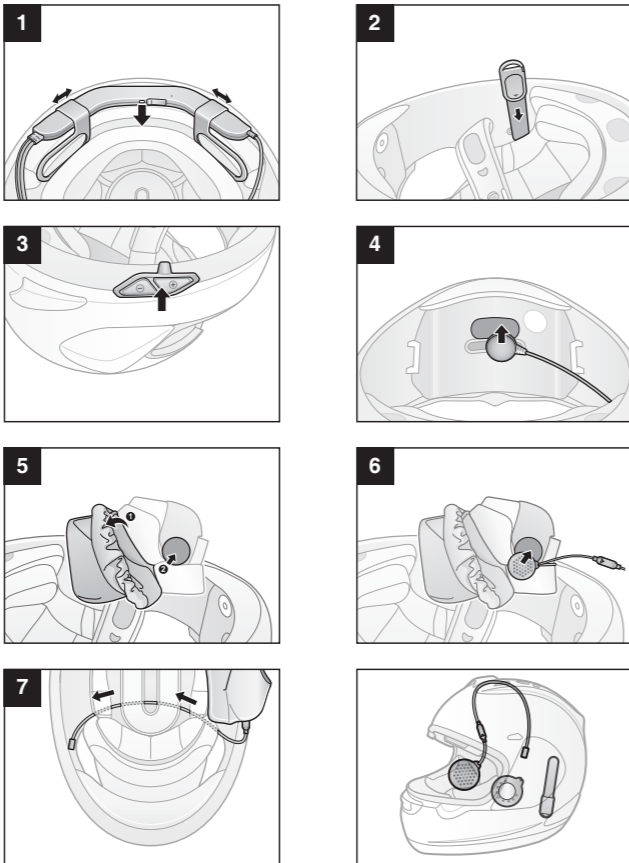

Opladen

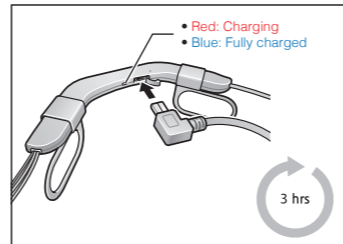

Bediening

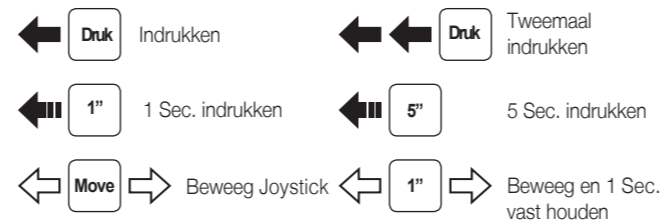

Aan/Uit

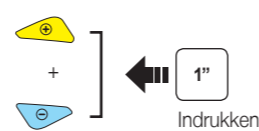

Volume Aanpassen

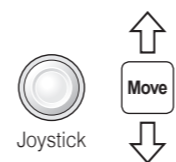

Bluetooth Pairing Telefoon en Muziek

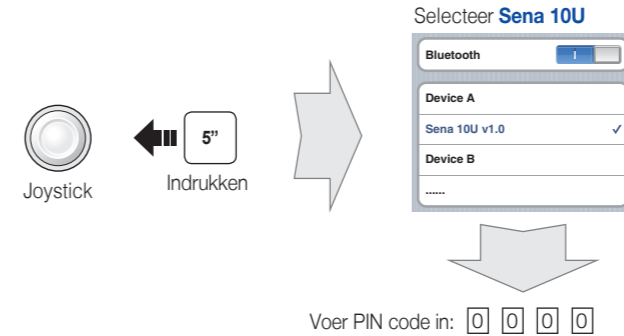

Muziek

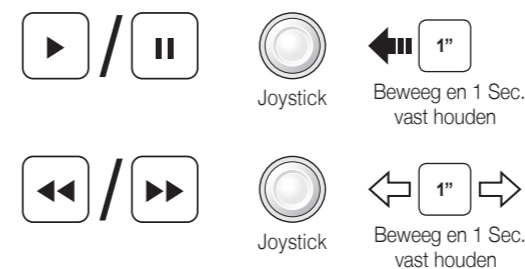

Mobiel bellen



Bluetooth Pairing Intercom

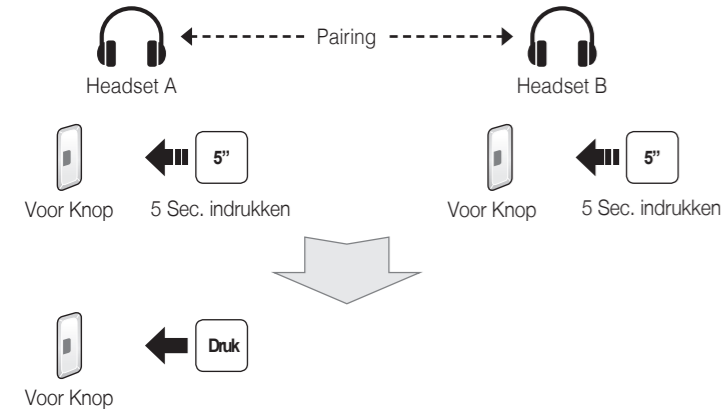

Intercom Start/Eind

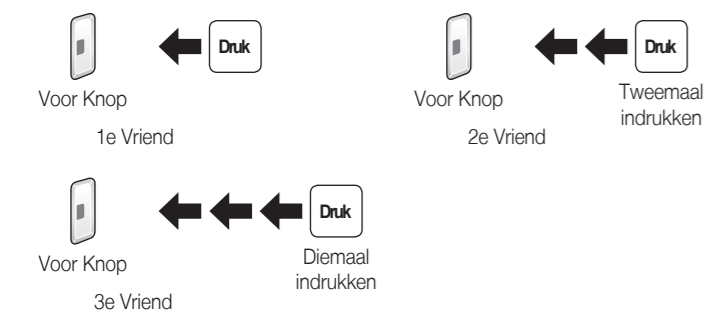

Radio Aan/Uit

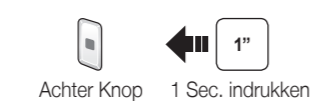

Radio Zoek Stations



Radio Scan FM Band

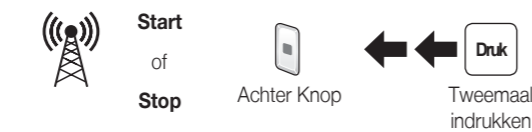

Station opslaan tijdens het scannen



Radio Luister Opgeslagen Station



Radio Station Opslaan/Verwijderen

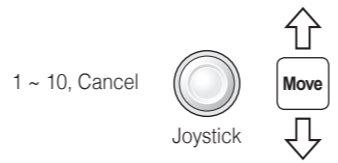

Setting

Configuratie Menu

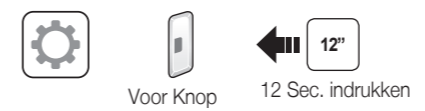

Sena Device Manager

Sluit de headset aan op uw computer met een USB-kabel. Start "Sena Device Manager" en klik op DEVICE SETTING om de headset te configureren.

De "Sena Device Manager" kunt u downloaden van www.sena.com.

Sena Smartphone App

- Download de Sena App op uw smartphone voor Android of iPhone via Google Play of App Store. Kijk op www.sena.com/app voor meer informatie.
- Pair uw smartphone met de headset.
- Open de Sena Smartphone App. Veeg over het scherm naar rechts en tik op Instellen om de headset te configureren.

Troubleshooting

Handlebar Remote Disconnection

OVGHHUEQGGVVHQGHDDQGOHEDUHPRHHQHDGVHRUG
 HUERHQVHPRHOMQRGGHDDQGOHEDUHPRHSHODGHQ
 QGHUVVHQGGHHDGVHEHGHQQVQRSSHQHEUHQ

OHUHQIRUPDRRHUGHHDGVHEHGHQQGGHQGHROOHGH
 HEUHVDDQGGHGGRRQORDGHQRSVHQDFRP

Fabrieksreset

If you want to restore the 10U to factory default settings, use the Factory Reset in the configuration menu. The headset automatically restores the default settings and turns off.

Reset

OVGHRPHHQEHSDDOGHUHGHHQHRHG
 HUGUGDQRRUFHQROH
 HVHQRSDDQGHDFHUDQQGGHHDGVH
 QHHDGVHUVHODRDPVFGH
 IDEUHVQVHOOQHQ



9 Yb' j c`YX][Y\ UbX'Y]X]b['jg'h'Xck b'cUXYb' j]U.'k k k "gYbU'Wta "



Hoco Parts B.V. Harselaarseweg 104
 3771 MB Barneveld The Netherlands www.hocoparts.nl
 T: +31 (0)342 - 412290 F: +31 (0)342 - 491749